

**FORMER RAMBLER PFS
BYPASS ROAD
TARVIN
CHESTER
CH3 8EF**



Location

The site is located on the Bypass Road A54, adjoining Fraser Chadick Motors and The Cooper Kettle Public House.

Description

The extent of the land is shown in red on the plan below and it consists of a cleared site which was a former petrol filling station. It has the following approximate dimensions and areas:-

Gross Frontage: 53 m

Site Area: 1,200 sq m.

General Information

My clients are considering their options with regards to potential future use for this site. However if interested parties wish to make a proposal all written offers will be reported to the client. No guide prices are being issued.

Viewing

The land can be viewed from the Bypass Road.

All other enquires to Owners Sole Agents:-

Wimpole Property Consultants - Robert Foux
Tel: 020 7580 3800
Email: robert@wimpole-property.co.uk

FORMER RAMBLER PFS BYPASS ROAD CHESTER CHESHIRE CH3 8EF

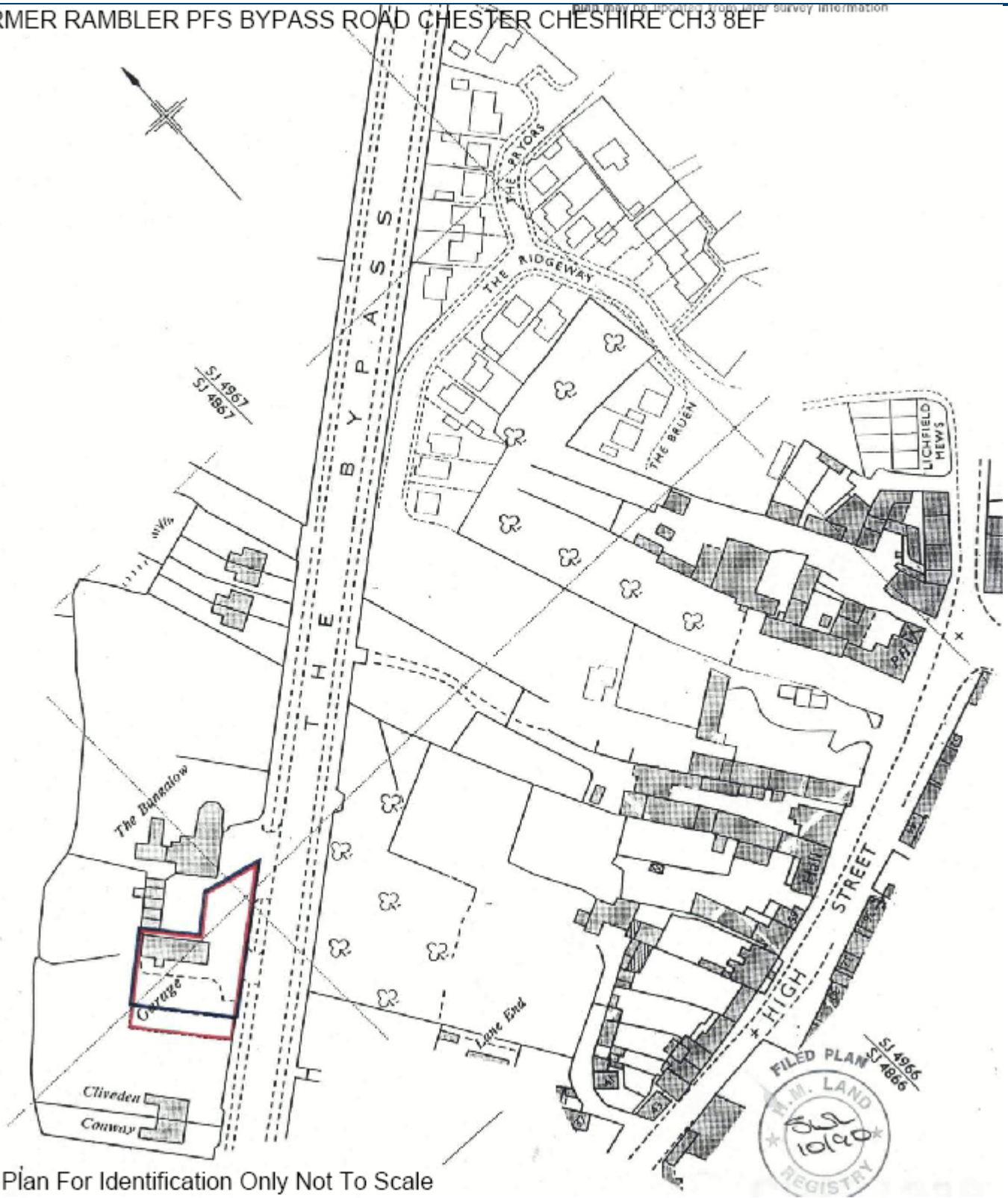

Site Plan For Identification Only Not To Scale

The Property Misdescriptions Act 1991

1. These particulars are prepared for guidance only to purchasers or Lessees and do not constitute, nor constitute part of, an offer or contract.
2. Any information contained herein (whether in text, plans or photographs) are given without responsibility and any intending Purchaser or Tenants should not rely on them as statements or representations of facts but must satisfy themselves by inspection or otherwise as to the correctness of each of them.
3. Any areas, measurements or distances referred to herein are approximate only.
4. The Vendors or Lessors do not make or give, and neither do Wimpole Property Consultants Limited for themselves nor any person in their employment has any authority to make or give any representation or warranty whatever in relation to this property.